



W  
WHITES

2 St Judes Close, Bishopdown Farm, Salisbury, Wiltshire, SP1 3FA

£1,150 PCM

## About The Property

This two-bedroom mid-terrace house is located in a pleasant cul-de-sac on the edge of a popular residential development. The accommodation includes an entrance hallway, a sitting room with sliding doors leading to the rear garden, and a kitchen equipped with an electric oven, a gas hob, space for a refrigerator, and space for a washing machine.

Upstairs, you'll find two bedrooms and a bathroom. Outside, there is an enclosed rear garden, a single garage, and driveway parking available. The property is unfurnished and has gas central heating (GCH).

- Two bedrooms
- Lounge/diner
- Single garage
- Good sized garden
- Unfurnished
- Gas central heating
- Off street parking for one car
- Available immediately

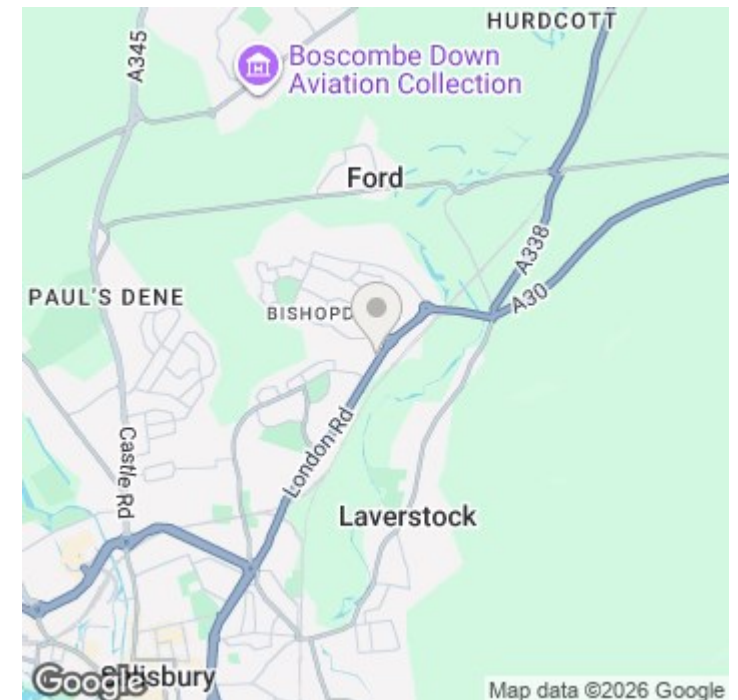



## Ground Floor

Approx. 27.6 sq. metres (297.2 sq. feet) 

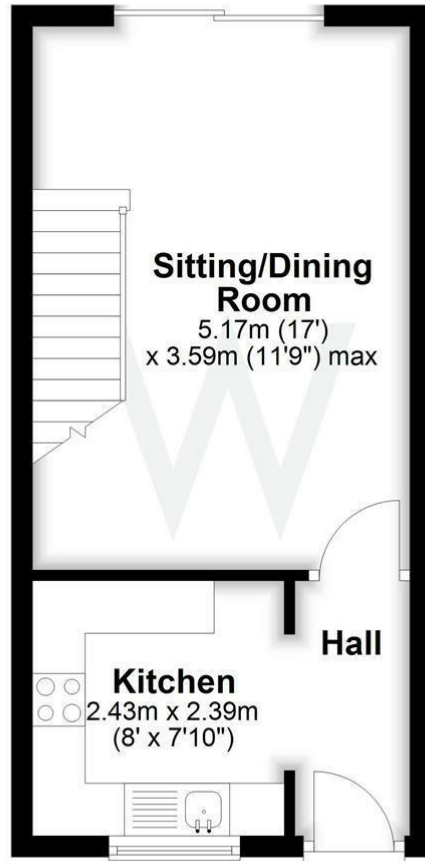

## First Floor

Approx. 26.9 sq. metres (289.0 sq. feet)

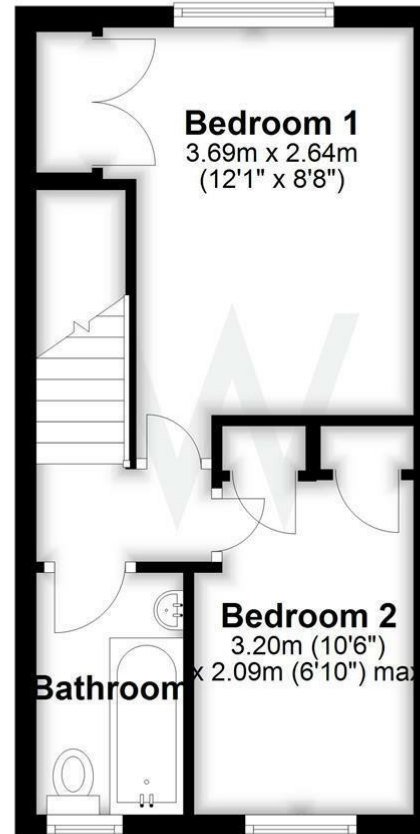

Total area: approx. 54.5 sq. metres (586.3 sq. feet)

## Further Information

Let available date: 12th June 2026  
NB: This date is provisional and will only be confirmed once referencing has been successfully completed.

Property type: House - Terraced

Furnish type: Unfurnished

Deposit: £1,325

Local authority: Wiltshire Council

Council Tax: Band C

EPC: D(67)

### Energy Efficiency Rating

|   | Current                    | Potential   |
|---|----------------------------|---|
| Very energy efficient - lower running costs |                            |   |
| (92 plus) <b>A</b>                          |                            |   |
| (81-91) <b>B</b>                            |                            | <b>86</b>   |
| (69-80) <b>C</b>                            |                            |   |
| (55-68) <b>D</b>                            | <b>67</b>                  |   |
| (39-54) <b>E</b>                            |                            |   |
| (21-38) <b>F</b>                            |                            |   |
| (1-20) <b>G</b>                             |                            |   |
| Not energy efficient - higher running costs |                            |   |
| <b>England &amp; Wales</b>                  | EU Directive<br>2002/91/EC |  |